

LED Floodlight

LEDioc Floodlight Class 30

ECF0398D(N,W,LW,L)/SAN8/DG(W)
ECF0397D(N,W,LW,L)/SAN8/DG(W)
ECF0396D(N,W,LW,L)/SAN8/DG(W)
ECF0395D(N,W,LW,L)/SAN8/DG(W)

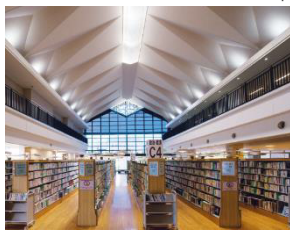

Example of Construction (Image)

- Capable of delivering brightness equivalent to a 70W metal halide lamp (5000K/Ra70 type)
- Proprietary light distribution control technology allows for four types of luminous intensity distribution: narrow, medium, wide and super wide beam
- Lineup : 6500K, 5000K, 4000K, 3000K, 2700K
- High Colour Rendering (Ra80) version allows for vivid illumination of objects
- A highly efficient (142.4lm/W) version is also available in 5000K (super wide beam / Ra70)
- "Any Position" structure allows for various mounting directions and installation
- Quickly reaches full brightness
- Long life : 60,000 hours
- Utilizes highly efficient/high-powered COB-type LED package

Offering top-class energy saving performance, this series has been created through a careful combination of lens and mirror technology, and efficient usage of electrical power. With COB (Chip on board) type lighting, large numbers of LED devices are mounted directly onto substrate. With light therefore being emitted from a single, uniform surface, an even and natural level of brightness can be achieved.



Product Series

Model Number	Consumption	CCT	CRI	Luminous Flux	Beam Angle	Luminous Efficacy
ECF0398D/SAN8/DG(W)	33W	6500K	70	4180 lm	Narrow beam	126.6 lm/W
ECF0398N/SAN8/DG(W)	33W	5000K	70	4400 lm	Narrow beam	133.3 lm/W
ECF0398W/SAN8/DG(W)	33W	4000K	80	3980 lm	Narrow beam	120.6 lm/W
ECF0398LW/SAN8/DG(W)	33W	3000K	80	3770 lm	Narrow beam	114.2 lm/W
ECF0398L/SAN8/DG(W)	33W	2700K	80	3610 lm	Narrow beam	109.3 lm/W
ECF0397D/SAN8/DG(W)	33W	6500K	70	4180 lm	Medium beam	126.6 lm/W
ECF0397N/SAN8/DG(W)	33W	5000K	70	4400 lm	Medium beam	133.3 lm/W
ECF0397W/SAN8/DG(W)	33W	4000K	80	3980 lm	Medium beam	120.6 lm/W
ECF0397LW/SAN8/DG(W)	33W	3000K	80	3770 lm	Medium beam	114.2 lm/W
ECF0397L/SAN8/DG(W)	33W	2700K	80	3610 lm	Medium beam	109.3 lm/W
ECF0396D/SAN8/DG(W)	33W	6500K	70	4180 lm	Wide beam	126.6 lm/W
ECF0396N/SAN8/DG(W)	33W	5000K	70	4400 lm	Wide beam	133.3 lm/W
ECF0396W/SAN8/DG(W)	33W	4000K	80	3980 lm	Wide beam	120.6 lm/W
ECF0396LW/SAN8/DG(W)	33W	3000K	80	3770 lm	Wide beam	114.2 lm/W
ECF0396L/SAN8/DG(W)	33W	2700K	80	3610 lm	Wide beam	109.3 lm/W
ECF0395D/SAN8/DG(W)	33W	6500K	70	4460 lm	Super Wide beam	135.1 lm/W
ECF0395N/SAN8/DG(W)	33W	5000K	70	4700 lm	Super Wide beam	142.4 lm/W
ECF0395W/SAN8/DG(W)	33W	4000K	80	4160 lm	Super Wide beam	126.0 lm/W
ECF0395LW/SAN8/DG(W)	33W	3000K	80	3930 lm	Super Wide beam	119.0 lm/W
ECF0395L/SAN8/DG(W)	33W	2700K	80	3780 lm	Super Wide beam	114.5 lm/W

Specifications

- Operation Temperature Range : -20~+35°C
- IP Code : IP65

Optical

- Beam Angle : Narrow/ Medium/ Wide/ Super Wide beam
- 1/10 Beam Angle : 72° / 78° / 80° × 104° / 130° × 148°
- Color Rendering Index : 70 or 80
- Rated Luminous Flux : 3610 - 4700 lm
- Luminous Efficacy : 109.3 – 142.4 lm/W
- Lumen Maintenance (L80) : 60,000 hours at 35°C

Electrical

- Built-in Power Supply
- Input Voltage : 100/200-242V
- Line Frequency : 50/60Hz
- Power Consumption : 33W

Mechanical

- Body(except front part) : Diecast aluminum
- Front Cover : Tempered glass
- Finish Color : Dark grey or White

Physical

- Dimensions : W200×H236×D108mm
- Weight : 2.8kg

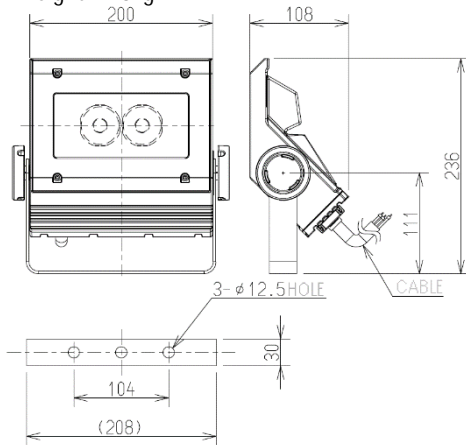

Lighting Image

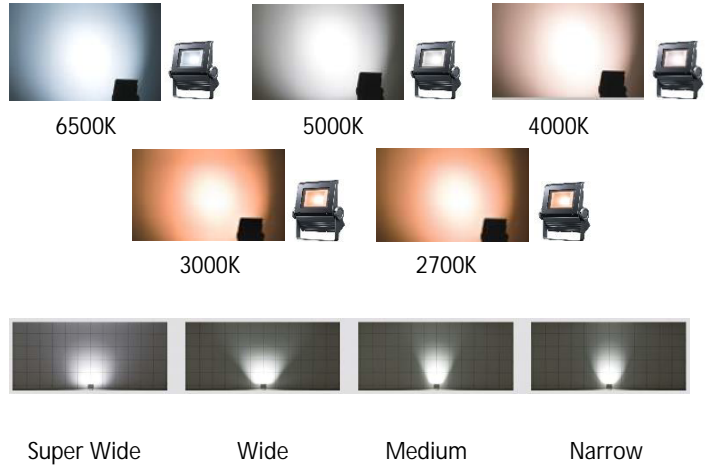

Photometric

ECF0398N/SAN8/DG(W)
CCT : 5000K , CRI : 70
Beam Angle : **Narrow**

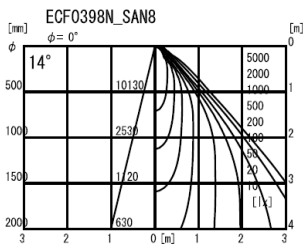

*The angle is 1/2 illuminance angle, not beam angle.

ECF0397N/SAN8/DG(W)
CCT : 5000K , CRI : 70
Beam Angle : **Medium**

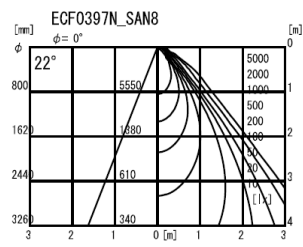

*The angle is 1/2 illuminance angle, not beam angle.

ECF0396N/SAN8/DG(W)
CCT : 5000K , CRI : 70
Beam Angle : **Wide**

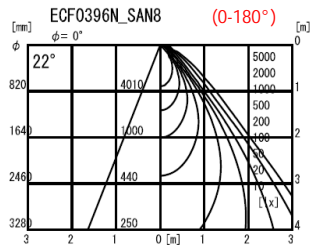
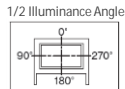

*The angle is 1/2 illuminance angle, not beam angle.

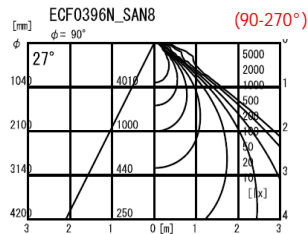

*The angle is 1/2 illuminance angle, not beam angle.

ECF0395N/SAN8/DG(W)
CCT : 5000K , CRI : 70
Beam Angle : **Super Wide**

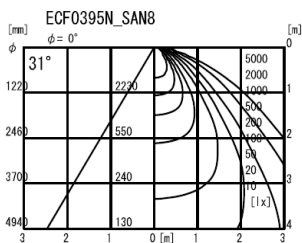

*The angle is 1/2 illuminance angle, not beam angle.