

## LED Flood Light

## LED Floodlight Class 20

ECF2040N/D(N,W,L,NH)SAN8/DG(W)  
 ECF2040M/D(N,W,L,NH)SAN8/DG(W)  
 ECF2040W/D(N,W,L,NH)SAN8/DG(W)  
 ECF2040SW/D(N,W,L,NH)SAN8/DG(W)



Dark gray



White

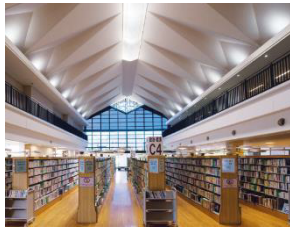

Example of Construction (Image)

- Capable of delivering brightness equivalent to 70W metal halide lamp (5000K/Ra70 type)
- Proprietary light distribution control technology allows for four types of luminous intensity distribution: narrow, medium, wide and super wide beam
- Lineup : 6500K, 5000K, 4000K, 2700K, 2100K
- Ra80 high color rendering vividly illuminates objects
- The 5000K type also includes a highly efficient 145lm/W (5000K/super wide)
- Any position structure allows for various mounting directions and installation
- Quickly reaches full brightness
- Long life : 60,000 hours
- Utilizes highly efficient/high-powered COB-type LED package\*

This light source, offering top-class energy saving performance has been achieved through a new optical design utilizing both a lens and a mirror, and also through highly efficient usage of electric power. With COB (Chip on board) type lighting, large numbers Of LED devices are mounted directly onto substrate. As light is therefore emitted from a single uniform surface, a natural lighting environment of even brightness close to that created by surface emission can be achieved.



## Product Series

Model Number	Power Consumption	CCT	CRI	Luminous Flux	Beam Angle	Luminous Efficacy
ECF2040N/DSAN8/DG(W)	24.0W	6500K	70	2500 lm	Narrow beam	104.1 lm/W
ECF2040N/NSAN8/DG(W)	24.0W	5000K	70	2700 lm	Narrow beam	112.5 lm/W
ECF2040N/WSAN8/DG(W)	24.0W	4000K	80	2400 lm	Narrow beam	104.1 lm/W
ECF2040N/LSAN8/DG(W)	24.0W	2700K	80	2100 lm	Narrow beam	87.5 lm/W
ECF2040N/NHSAN8/DG(W)	24.0W	2100K	65	2300 lm	Narrow beam	95.8 lm/W
ECF2040M/DSAN8/DG(W)	26.2W	6500K	70	3300 lm	Medium beam	125.9 lm/W
ECF2040M/NSAN8/DG(W)	26.2W	5000K	70	3500 lm	Medium beam	133.5 lm/W
ECF2040M/WSAN8/DG(W)	26.2W	4000K	80	3100 lm	Medium beam	118.3 lm/W
ECF2040M/LSAN8/DG(W)	26.2W	2700K	80	2800 lm	Medium beam	106.8 lm/W
ECF2040M/NHSAN8/DG(W)	26.2W	2100K	65	3000 lm	Medium beam	114.5 lm/W
ECF2040W/DSAN8/DG(W)	26.2W	6500K	70	3200 lm	Wide beam	122.1 lm/W
ECF2040W/NSAN8/DG(W)	26.2W	5000K	70	3400 lm	Wide beam	129.7 lm/W
ECF2040W/WSAN8/DG(W)	26.2W	4000K	80	3000 lm	Wide beam	114.5 lm/W
ECF2040W/LSAN8/DG(W)	26.2W	2700K	80	2700 lm	Wide beam	103.0 lm/W
ECF2040W/NHSAN8/DG(W)	26.2W	2100K	65	2900 lm	Wide beam	110.6 lm/W
ECF2040SW/DSAN8/DG(W)	26.2W	6500K	70	3400 lm	Super Wide beam	129.7 lm/W
ECF2040SW/NSAN8/DG(W)	26.2W	5000K	70	3800 lm	Super Wide beam	145.0 lm/W
ECF2040SW/WSAN8/DG(W)	26.2W	4000K	80	3200 lm	Super Wide beam	122.1 lm/W
ECF2040SW/LSAN8/DG(W)	26.2W	2700K	80	2900 lm	Super Wide beam	110.6 lm/W
ECF2040SW/NHSAN8/DG(W)	26.2W	2100K	65	2400 lm	Super Wide beam	91.6 lm/W

## Specifications

- Operation Temperature Range : -20~+35°C
- IP Code : IP65

## Optical

- Beam Angle : Narrow/ Medium/ Wide/ Super Wide beam
- 1/10 Beam Angle : 30° / 58° / 102° × 110° / 138° × 136°
- Color Rendering Index : 70 or 80 or 65
- Rated Luminous Flux : 2100 - 3800 lm
- Luminous Efficacy : 95.8 - 145.0 lm/W
- Lumen Maintenance (L80) : 60,000 hours at 35°C

## Electrical

- Built-in Power Supply
- Input Voltage : 100/200-242V
- Line Frequency : 50/60Hz
- Power Consumption : 24W or 26.2W

## Mechanical

- Body(except front frame) : Die casting aluminum
- Front Cover : Tempered glass
- Finish Color : Dark grey or White

\*SMD LED for Super Wide

## Physical

- Dimension : W158×H194×D80mm
- Weight : 2.0kg

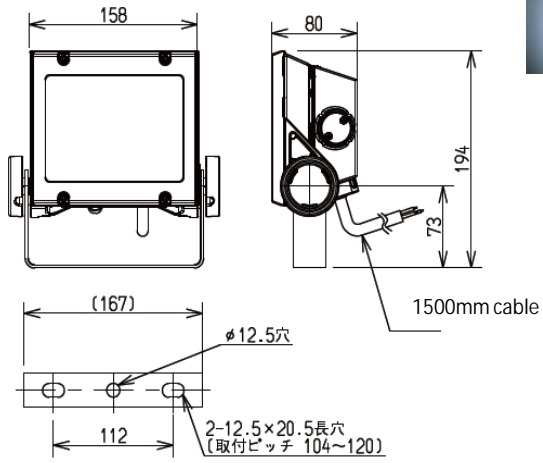

## Lighting Image

